

STAINLESS STEEL

PROFILES





MOVEMENT JOINT PROFILES



MOVEMENT JOINT

Movement Joint Profile in Stainless Steel (304) has been designed so that it can withstand heavy weights and spread the load evenly across the floor and foundations.

Thickness mm	Length mm	Material
1.0	2440	Stainless Steel

Height mm

20	25
DS-MJ1 B20-T10	DS-MJ1 B25-T10

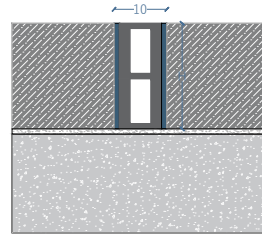

MOVEMENT JOINT

Thickness mm	Length mm	Material
1.0	2440	Stainless Steel

Height mm

20	25
DS-MJ2 B20-T10	DS-MJ2 B25-T10

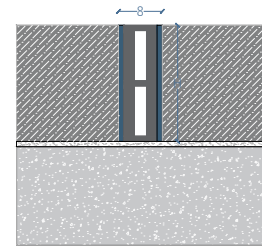

MOVEMENT JOINT

Height mm	Length mm	Material
12.5	2440	Stainless Steel

Thickness mm

0.8	1.0
DS-MJ3 B125-T8	DS-MJ3 B125-T10

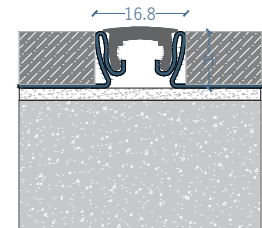

MOVEMENT JOINT

Height mm	Length mm	Material
12.5	2440	Stainless Steel

Thickness mm

0.8	1.0
DS-MJ4 B125-T8	DS-MJ4 B125-T10

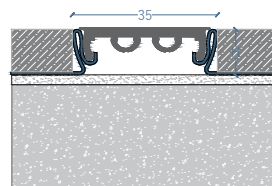

ALUMINIUM

PROFILES

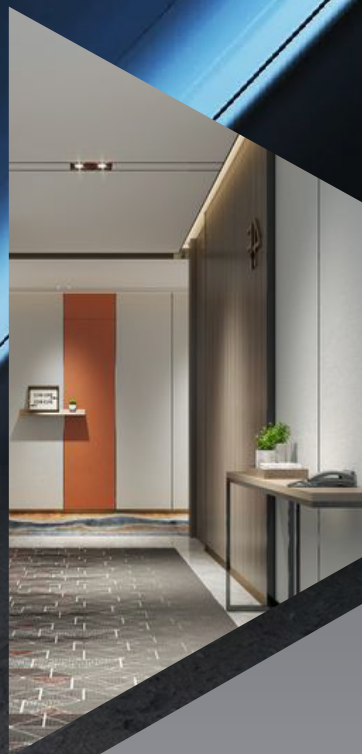



MOVEMENT JOINT PROFILES

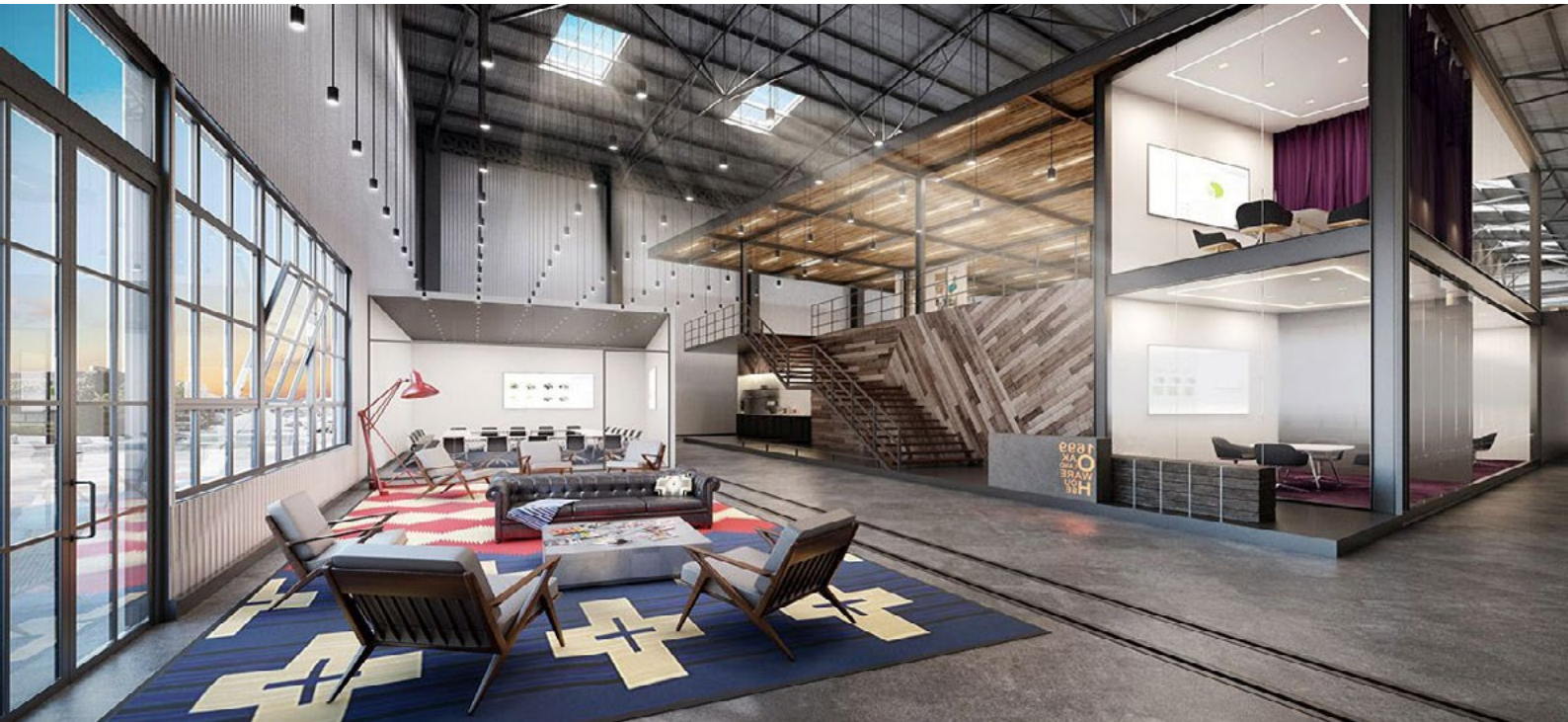

MOVEMENT JOINT

Movement Joint Profile in Aluminum has been designed so that it can withstand heavy weights and spread the load evenly across the floor and foundations.

Height mm	Length mm	Material
10	2500	Aluminium

DA-MJI-10

Height mm	Length mm	Material
12	2500	Aluminium

DA-MJI-12

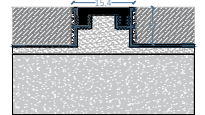

MOVEMENT JOINT

Movement Joint made of Aluminum with EPDM

Height mm	Length mm	Material
10	2500	Aluminium

DA-MJ2-10

Height mm	Length mm	Material
12	2500	Aluminium

DA-MJ2-12

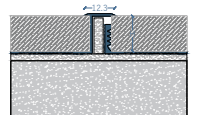

MOVEMENT JOINT



MOVEMENT JOINT

Height mm	Length mm	Material
20	2500	Aluminium

DA-MJ3-20

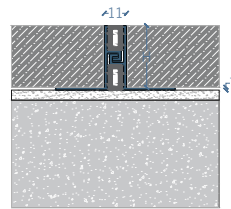

MOVEMENT JOINT

Height mm	Length mm	Material
20	3000	Aluminium

DA-MJ4-20

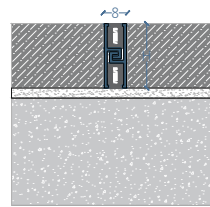

MOVEMENT JOINT

Height mm	Length mm	Material
20	3000	Aluminium

DA-MJ5-20

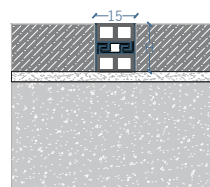

MOVEMENT JOINT

Height mm	Length mm	Material
30	3000	Aluminium

DA-MJ6-30

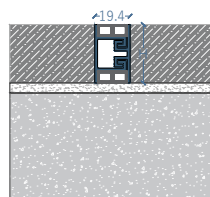



MOVEMENT JOINT

Height mm **Length mm** **Material**

15

2500

Aluminium

DA-MJ7-15

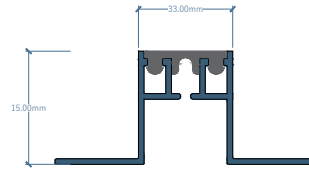

MOVEMENT JOINT

Height mm **Length mm** **Material**

15

2500

Aluminium

DA-MJ8-15

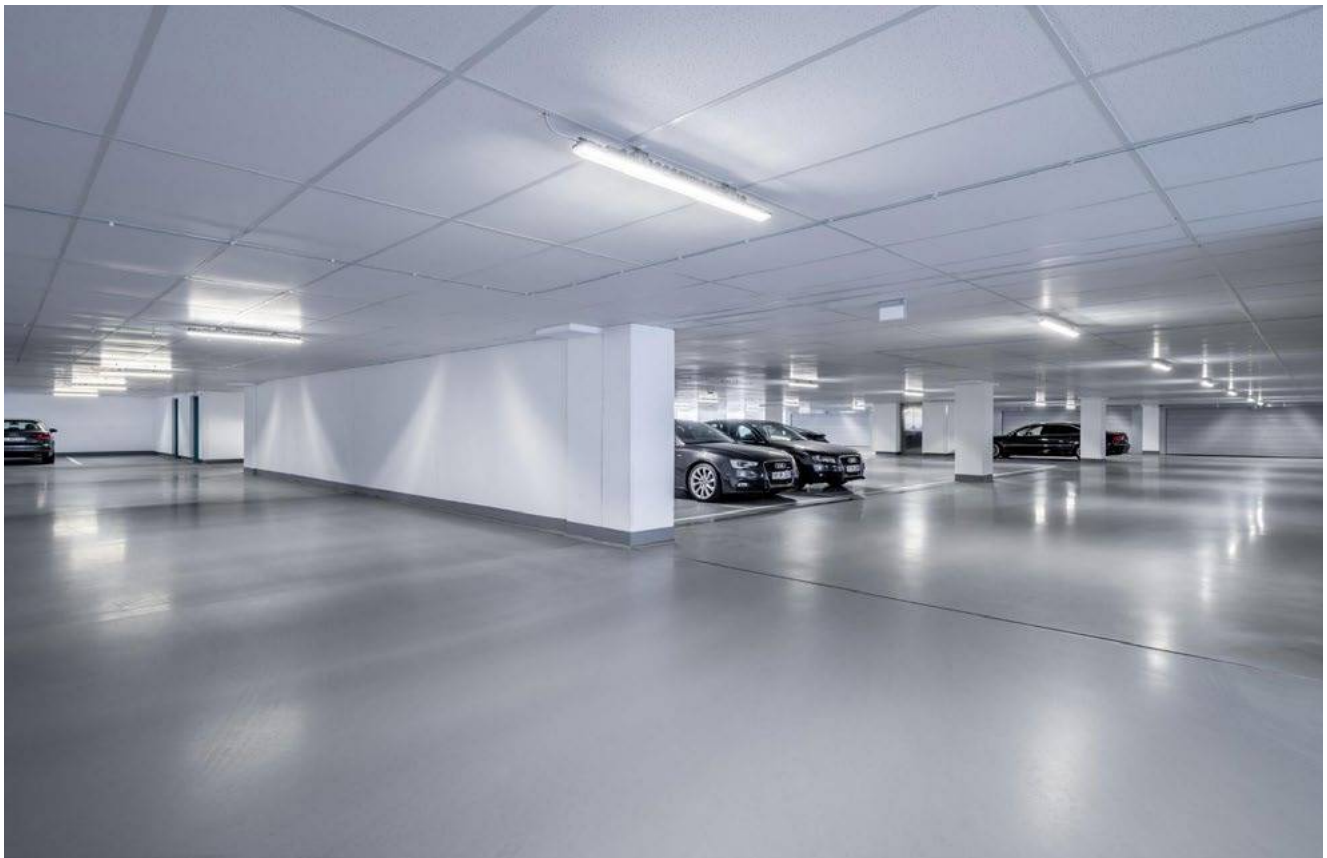
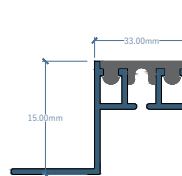

MOVEMENT JOINT